



Product Highlights

- ▣ **Textual Display of network / resource name** • The RDC440 color LCD presents available network numbers along with administrator programmable network / resource name in clear text. Up to 16 channels may be displayed and controlled through the RDC440.
- ▣ **Custom network / resource color** • The RDC440 LCD enables network / resource name coloring customization by system administrator to enable easy user recognition.
- ▣ **Easy KVM control through digital rotary encoder** • Large rotary encoder with rotation and push functions enable precision KVM user control.
- ▣ **Easy configuration using keyboard or microSD card** • enables easy deployment of multiple systems using Save and Load functions and microSD storage card. Single device programming is done through standard USB keyboard.
- ▣ **Manual and automatic display backlight adjustment** • The RDC color LCD designed to operate in wide range of lighting conditions. High dimming ratio available through manual brightness control or through ambient light sensor automatic control.
- ▣ **Highest security by design** • product is Common Criteria EAL 4+ approved (pending). This is the first and only remote KVM system to be certified.
- ▣ **Active anti tampering** • always-on active anti-tampering with 10 years battery. Special holographic tampering evident labels.
- ▣ **Multilanguage support** • the RDC440 supports network / resource name customization in English, German, French, Spanish, and Russian.

Secure KVM Remote Desktop Controller

Having multiple computers for each user due to security policy is not only a challenge for the IT staff it is also a challenge to the users. Even with the use of Secure KVMs, user experience and efficiency suffers.

The RDC440 is a major enhancement to HSL's Secure KVM products. This product provides an easy and intuitive desktop user interface to control complex Secure KVM systems. This product enables textual browsing of the available networks / resources through color display. This product significantly improves user's situational awareness and therefore enhances security and productivity for users that operates continuously in multiple domains secure environments.

This product is connected through CAT-5 or higher cable to any one of HSL's compatible Secure KVM switches, Secure KMs and Secure KVM Combiner. It enables remote control of all KVM functions including channel selection and DPP operation.

The RDC440 passed extensive security evaluation through all forms of known KVM attacks and was certified to Common Criteria EAL 4+.

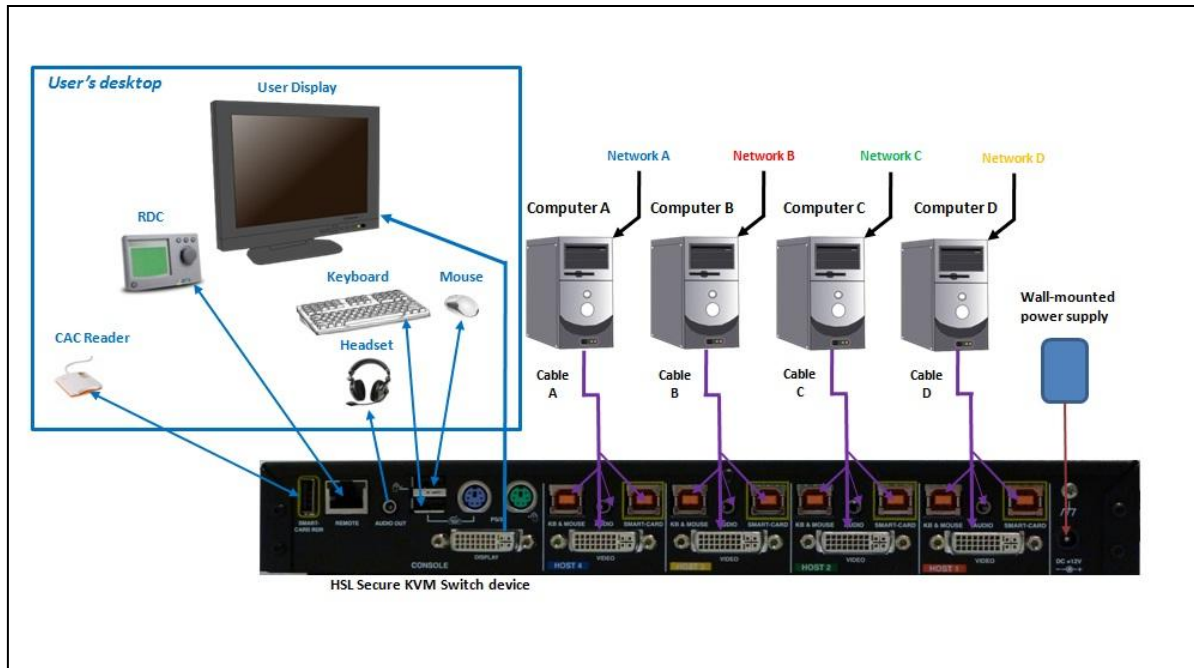

RDC typical system diagram with K204E 4-Port Secure KVM

RDC440 Specification

Number of channels supported	Up to 16
User interfaces	<ul style="list-style-type: none"> 3.2" Color TFT display One rotary encoder with push action DPP mode push-button
Electrical Interfaces	<ul style="list-style-type: none"> RJ-45 jack for HSL's RDC bus. This interface uses standard CAT-5 LAN cable. Mini-USB A female connector for administrator keyboard connection (adapter cable must be ordered separately) microSD card slot to save load configurations.
Display specifications	<ul style="list-style-type: none"> Size – 3.2" diagonal. Resolution - 240 (RGB) x 400 (Landscape). Display Color Depth – 65K. Display technology - a-Si with white LEDs for backlight
Security Functions	<ul style="list-style-type: none"> Improved User Situational Awareness through clear indications of selected channel number as well as programmable text and color. Firmware resides on ROM. Battery powered anti-tampering system to disable product in case of mechanical intrusion. Special holographic Temper Evident Label. Administrator setup unlock function using microSD unlock card
Power	<ul style="list-style-type: none"> 5V DC, 1A (maximum) from connected Secure KVM unit Power consumption 12W maximum, 4W nominal.
Sensors	<ul style="list-style-type: none"> One ambient light sensor.

Environmental	<ul style="list-style-type: none"> Temperature range: Operating - 0°C to 40°C (32°F to 104°F); Storage - -20°C to 60°C (-4°F to 140°F) Humidity: Operating - 20 to 80% non condensing; Storage – 10 to 90% non condensing Altitude: 0 to 10,000 ft
Regulatory Compliance	<ul style="list-style-type: none"> Safety: UL/cUL60950, EN60 950 EMI/EMC: FCC Class B, CE Mark, EN55022B, VCCI
Security Accreditations	<ul style="list-style-type: none"> Common Criteria EAL 4+ (currently in evaluation) Complies with NIAP latest Peripheral Sharing Switch (PSS) For Human Interface Devices Ver 2.1
Physical Characteristics	<ul style="list-style-type: none"> Dimensions: 140 (W) x 90 (D) x 110 (H) mm / 5.51 (W) x 3.54 (D) x 4.34 (H) inch Device weight: 0.25 Kg. (0.55 lbs.)
Warranty, Reliability	<ul style="list-style-type: none"> Two years limited warranty. This limited warranty covers 100% of parts and workmanship on any required repairs. For details see HSL web-site: www.highseclabs.com/Warranty.html Optional extended warranty for up to 5 additional years Product design life-cycle 10 years

- Specifications are subjected to change without prior notice

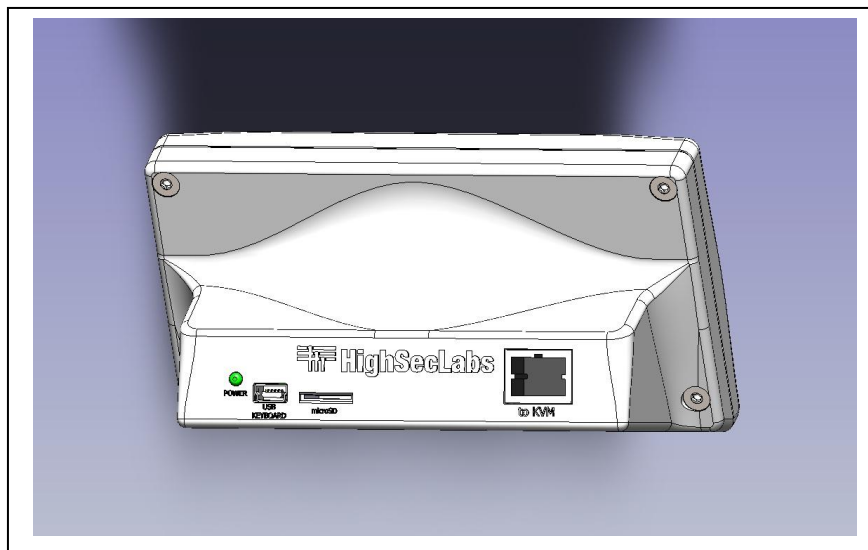

RDC440 Rear panel view

How to Order

RDC Models

Description	Part Number
RDC440 – 2 to 16 Port Remote Desktop Controller for Secure KVM, 3.2" QVGA color display, rotary encoder, Mini-USB and microSD ports, Silver	CPN06125

Cables

Description	Part Number
Cable - CAT-5E LAN, 1.8m, Blue	CPN06191

Accessories and spare parts

Description	Part Number
RDC Programming Kit including Mini-USB to USB-A adapter and microSD card	CPN06192

Services

Description	Part Number
RDC One year Standard warranty and support extension (3rd to 7th year) per S/N	HSV06189
RDC One year Premium warranty and 24/7 support per S/N	HSV06190